



Greetings, neighbors!

2011 Event

The Colorado Dragon Boat Festival (CDBF) will once again take place at Sloan's Lake Park for our 11th year on **Saturday, July 30th** and **Sunday, July 31st**. CDBF is a FREE family-friendly festival highlighting Colorado's rich Asian Pacific American heritage. This two-day celebration provides a window into the pan-Asian world, showcasing traditional and contemporary performing arts, cultural customs and cuisine, a marketplace of unique arts, crafts and vendors, and Dragon Boat racing featuring regional and national teams.

The CDBF Board, Staff and Operations Committee would like to thank you for your continued support, which has allowed us to manage our festival growth and maintain a high quality and safe event. As festival organizers, we truly appreciate you welcoming us into your community each year as we strive to be as neighborhood-friendly as possible. For your convenience, we have provided information on our 2011 Festival Traffic Plan below and on the reverse page.

Traffic Plan

The festival will be located on the northwest side of the lake along Sheridan and W. Byron. CDBF has consulted with and received approval from the Denver Traffic Engineers and Public Works Departments, Denver Police, and Fire Departments for a plan that emphasizes safety and helps manage and minimize vehicle traffic in your neighborhood.

To allow quick and safe access for emergency vehicles during the weekend, the Denver Fire Department has required "No Parking" areas for the following streets: Zenobia, Yates, Xavier, Wolff, Oak and Winona. Other major streets on the map are designated as "Road Closed," "Road Closed to Thru Traffic," or "Road Closed – Local Traffic Only."

Off-duty officers and security guards will be on hand to support this traffic plan. However, our Denver law enforcement team cannot distinguish between the cars of residents and those of festival attendees. Therefore, we graciously ask that you park in your garages, behind your homes as permitted or outside of these parking perimeters.

Alternative Transportation

CDBF is proud to announce the return of the shuttle program! Festival attendees can park at INVESCO Field for a small fee (\$5) and take a designated shuttle to the festival grounds. Anyone coming to INVESCO Field via RTD bus will also be able to take advantage of this FREE shuttle. In keeping with our "Greening the Dragon" Initiative, we are also offering two on-site bike and scooter corrals, to encourage people to cycle to the event.

Working Together

The CDBF Board, Staff and Operations Committee all cherish our working relationship with the residents of the Sloan's Lake Neighborhood. We ask for your support to increase the level of safety and well being for you during the two days of our annual festival, as well as for those attending this popular event. We strive to leave the park as clean as when we arrived (if not cleaner), and work hard to ensure the festival is an easy adjustment for our Sloan's Lake neighbors. We invite you to join us this year to celebrate CDBF's 11th anniversary, sample the Asian Pacific cuisine and wares for sale in the Marketplace, enjoy the eclectic performances on many stages for all ages, and cheer on the exciting Dragon Boat races. It's free, family friendly and full of fun.

Thank you for your understanding and support. See you at the festival!

Best regards,
Erin Yoshimura
Executive Director
Colorado Dragon Boat Festival
www.cdbf.org

CONTACT INFORMATION:

Sloan's Lake residents may contact CDBF during festival hours by calling this **Hotline Number: 720-891-7542**

2011 Traffic Plan

Event dates and hours: Saturday, July 30th 10 am – 7 pm
 Sunday, July 31st 10 am – 5 pm

Traffic restrictions in place: Saturday & Sunday, 6 am – 10 pm; "No Parking" signs delivered Friday a.m.

2011 Transportation Options

- **Take the CDBF Shuttle!** CDBF is proud to announce the return of the shuttle service. Festival Patrons may reach this shuttle by taking the RTD bus to Invesco Field, or paying **\$5 for event parking** at Invesco Field (Lot G), then hop on the convenient **free** shuttles that will drop you off at the festival!
Note: RTD has informed CDBF that the INVESCO Field Light Rail Station will be closed during the festival (from July 23rd to August 14th) for maintenance.
- **Bike to the festival!** For the third year, CDBF will provide bike racks and small scooter (50cc or under) parking for a public donation. Bike/scooter corrals are located near the Southwest and East festival entrances. Bike routes and access information can easily be found on <http://maps.google.com> by clicking on "Get directions," then choosing the  icon.
- **Don't fuss –Take the bus!** Public transit is available through **RTD** bus routes #51 (runs along Sheridan), route #28 (runs along West 26th) and route #20 (runs along 17th Ave, up Sheridan and turns on 20th). Please visit www.rtd-denver.com for times, exact stops, and alternate routes, or phone 303-299-6000.
- **Walk to the festival!** CDBF encourages getting some exercise before indulging in Asian culinary delights by walking to the 2011 Festival.
- **Load up the car and drive together!** CDBF promotes carpooling to the festival with friends and family. The Sloan's Lake Park parking lots listed below are open to the public on a first come, first parked basis.
 - Sloan's Lake parking lot at Utica and 17th
 - Sloan's Lake parking lot at Raleigh and 17th
 - Sloan's Lake parking lot at Perry and 17th
- **Handicapped Parking:** Ample parking is available at Invesco Field and shuttle buses can accommodate wheelchairs. Handicapped access will be available at the festival site with a designated drop-off and pick-up area near Sheridan & Byron, for those with the proper credentials. **Limited handicapped parking** will also be offered along Denver Park Road accessible from Vrain St. on a first-come, first-served basis.

BEST BET!

Parking is available at INVESCO FIELD at Mile High to park in for \$5 per car and starting at Lot G. There is plenty of parking and a FREE SHUTTLE to transport festival goers to and from the festival site.

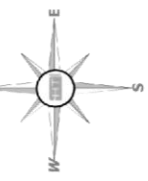

Dragon Boat Festival

Summary of Devices:

- 48 - No Parking Anytime
- 2 - 48" Road Work Ahead
- 4 - 48" Road Closed Ahead
- 1 - 48" Detour Ahead
- 1 - T-3 Road Closed TTT Double Detour
- 9 - T-1 Road Closed
- 28 - T-1 Road Closed TTT
- 10 - Glow Post
- 1 - No Left Turn

NOTE:
NO PARKING SIGNS TO BE DELIVERED
24 HOURS IN ADVANCE OF WORK.

<p>HIGHWAY TECHNOLOGIES Rental, Sales, Service Traffic Control - Sign Manufacturing & Installation - Guardrail Sales & Installation - Pavement Marking - Contractor Supplies</p>	<p>Traffic Control Division 2385 South Lipan St. Denver, CO 80232 Phone: (303) 922-7815 Fax: (303) 922-5433</p>
	<p>MHT #4 NOT DRAWN TO SCALE Page 1 of 2 REVISED BY: Ken Murphy 06-20-10</p>
<p>TRAFFIC CONTROL PLAN Location: Byron Pl. & Sheridan Blvd. City: Denver, CO 80237 For: Dragon Boat Festival Pamela Maragh 303.868.7069 Date: March 30, 2010 Drawn By: Ken Murphy</p>	

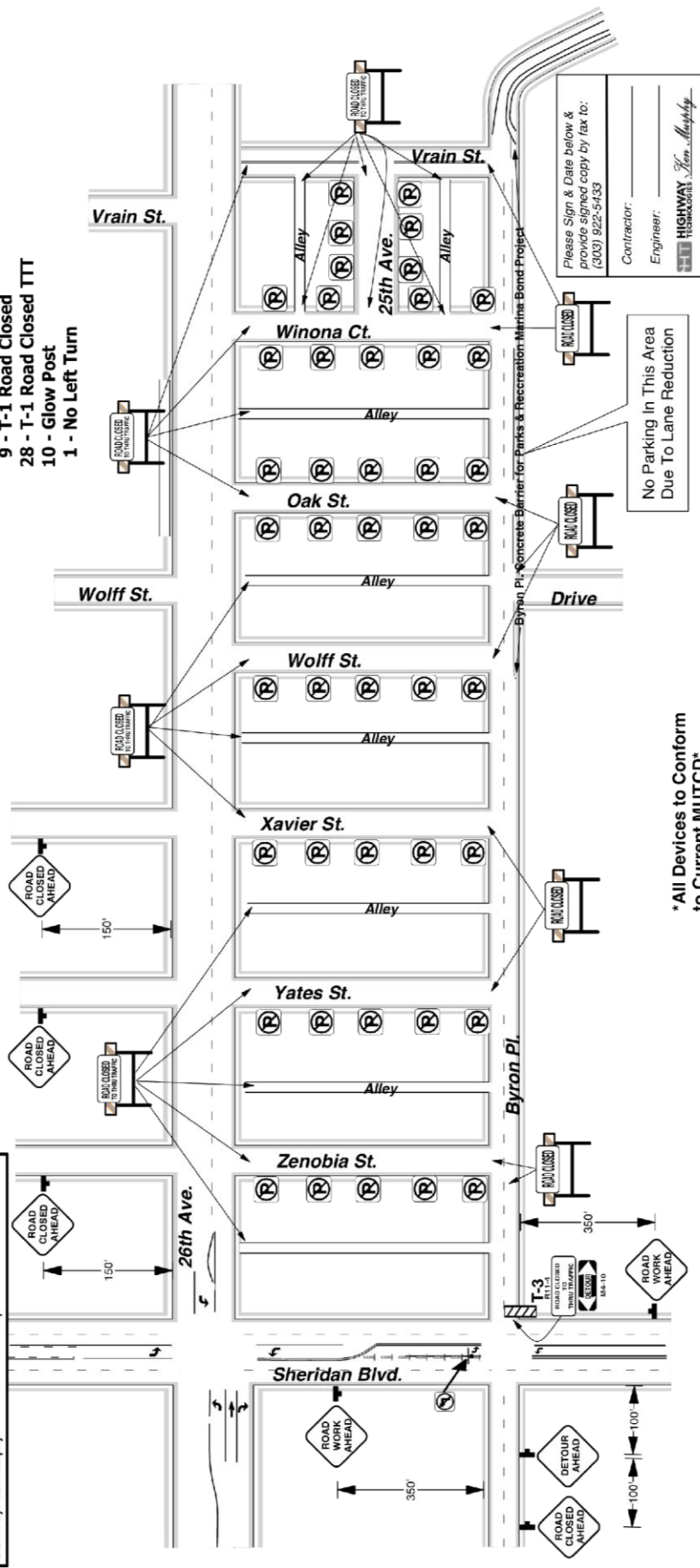

Please Sign & Date below & provide signed copy by fax to:
(303) 922-5433

Contractor: _____
Engineer: _____

HIGHWAY TECHNOLOGIES
Ken Murphy

No Parking In This Area
Due To Lane Reduction

* All Devices to Conform to Current MUTCD*

2011 SHUTTLE ROUTE AND DROP/LOAD ZONE

Shuttle Route - TO FESTIVAL

- 26th Ave. West to Wolf - left/south on Wolf
- Left/East on Byron to Vrain
- Left/North on Vrain to Shuttle Drop/Load zone

Shuttle Route - TO PARKING LOT

- North on Vrain to 26th
- Right/East on 26th to Parking Lot

Also Shown:

- Handicap Parking (white-Denver Park Drive) - both sides of street
- Food Vendor Parking (green-Denver Park Drive) - both sides of street
- Tennis Court Parking Lot (blue) and TC Oflow (overflow) lot (blue)
- Sponsors
- Main Stage Performers - timed
- GA performers - timed
- DL performers - timed

Elderly/handicap drop off/pick up area (blue)

Vendor/Sponsor/Performer drop off/loading zone - 30 min time limit (white)

